

GLAZING
VERGLASUNG
VITRAGE

997-077-52414

Figure
Bild
Figure

7752414

2600-05

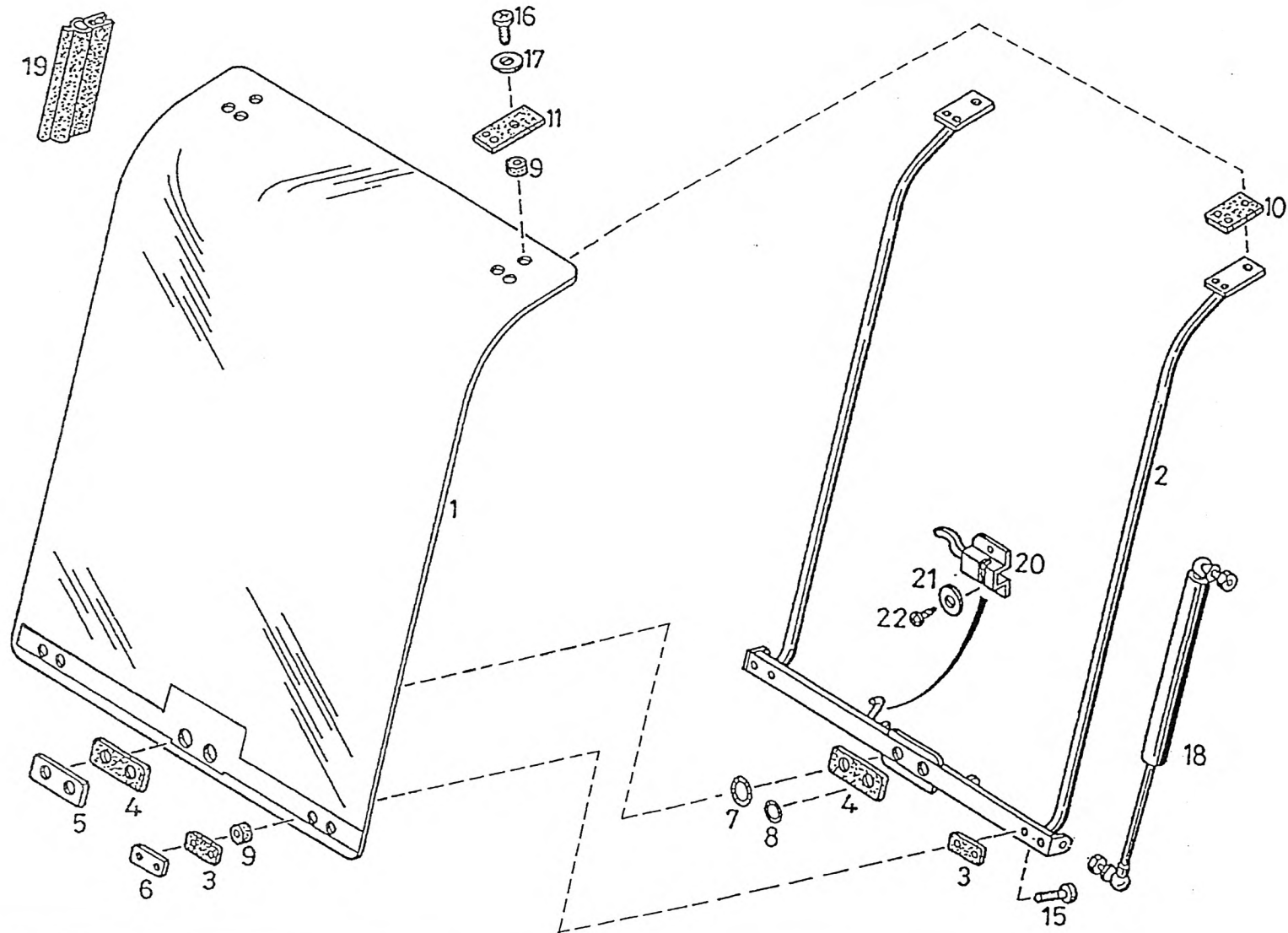

GLAZING
VERGLASUNG
VITRAGE

997-077-52414

Figure
Bild
Figure

7752414

2600-05



Item Pos. Réf	Part No. Tell-Nr. Pièce No	Designation Benennung Désignation	all alle tous	Qty/assy Stck/Variante Pièce/ensemble								Figure Bild Figure
				A	B	C	D	E	F	G	H	
1	997-077-18986	FRONT SCREEN FRONTSCHIEBE PARE BRISE	1									
2	997-077-27410	FRAME RAHMEN CADRE	1									
3	997-077-27421	PLATE GUMMIPLATTE PLAQUE	4									
4	997-077-27420	PLATE GUMMIPLATTE PLAQUE	2									
5	997-077-27417	PLATE BLECH PLAQUE	1									
6	997-077-27416	PLATE GEWINDEPLATTE PLAQUE	2									
7	997-084-02426	O-RING 20x4 O-RING JOINT TORIQUE	1									
8	997-000-21524	O-RING 16x4 O-RING JOINT TORIQUE	1									
9	997-085-11039	BUSHING BUCHSE DOUILLE	10									
10	997-077-27418	PLATE GUMMIPLATTE PLAQUE	2									
11	997-077-27419	PLATE GUMMIPLATTE PLAQUE	2									
15	997-007-66483	HEAD SCREW M6x30 LINSCHRAUBE VIS À TÊTE BOMBÉE	4									
16	997-067-09052	HEAD SCREW M6x25 LINSCHRAUBE VIS À TÊTE BOMBÉE	6									
17	997-001-04731	DISC 6,4 SCHEIBE RONDELLE	6									
18	997-077-51122	GAS SPRING 885 mm GASFEDER RESSORT A GAZ	2									

Item Pos. Réf	Part No. Tell-Nr. Pièce No	Designation Benennung Désignation	all alle tous	Qty/assy Stck/Variante Pièce/ensemble								Figure Bild Figure
				A	B	C	D	E	F	G	H	
19	997-070-07759	PROFILE PROFIL PROFILE	4,5m									
20	997-026-01633	LOCK VERSCHLUSS FERMETURE	1									
21	997-084-08994	DISC 5,3 SCHEIBE RONDELLE	2									
22	997-007-25479	TAPPING SCREW 4,8x13 BLECHSCHRAUBE VIS À TOLE	2									